

# FM/AM Digital Radio

## Operating Instructions



### XDR-S3HD

© 2007 Sony Corporation Printed in China

<http://www.sony.net/>

## Owner's Record

The model number and the serial number are located on the bottom. Record the serial number in the space provided below. Refer to them whenever you call upon your Sony dealer regarding this product.

Model No. XDR-S3HD

Serial No. \_\_\_\_\_

For customers who purchased this product in the USA Please register this product on line at <http://www.sony.com/productregistration>. Proper registration will enable us to send you periodic mailings about new products, services, and other important announcements. Registering your product will also allow us to contact you in the unlikely event that the product needs adjustment or modification. Thank you.

## WARNING

To reduce the risk of fire or electric shock, do not expose this apparatus to rain or moisture.

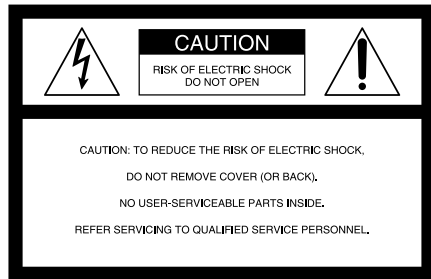

This symbol is intended to alert the user to the presence of uninsulated "dangerous voltage" within the product's enclosure that may be of sufficient magnitude to constitute a risk of electric shock to persons.

This symbol is intended to alert the user to the presence of important operating and maintenance (servicing) instructions in the literature accompanying the appliance.

\* The graphical symbols are on the bottom enclosure.

## INFORMATION

This equipment has been tested and found to comply with the limits for a Class B digital device, pursuant to Part 15 of the FCC Rules. These limits are designed to provide reasonable protection against harmful interference in a residential installation. This equipment generates, uses, and can radiate radio frequency energy and, if not installed and used in accordance with the instructions, may cause harmful interference to radio communications. However, there is no guarantee that interference will not occur in a particular installation. If this equipment does cause harmful interference to radio or television reception, which can be determined by turning the equipment off and on, the user is encouraged to try to correct the interference by one or more of the following measures:

- Reorient or relocate the receiving antenna.
- Increase the separation between the equipment and receiver.
- Connect the equipment into an outlet on a circuit different from that to which the receiver is connected.
- Consult the dealer or an experienced radio/ TV technician for help.

You are cautioned that any changes or modifications not expressly approved in this manual could void your authority to operate this equipment.

HD Radio™ Technology Manufactured Under License From iBiquity Digital Corporation. iBiquity Digital, the HD Radio logo, and the HD logo are registered trademarks of iBiquity Digital Corporation. HD Radio™ is a trademark of iBiquity Digital Corporation. U.S. and Foreign Patents.

## Note to the CATV Installer

This reminder is provided to call the CATV system installer's attention to Article 820-40 of the NEC that provides guidelines for proper grounding and, in particular, specifies that the cable ground shall be connected to the grounding system of the building, as close to the point of cable entry as practical.

## What is HD Radio™ Technology?

HD Radio Broadcasting was approved by the Federal Communications Commission in October 2002 as the system for digital AM and FM broadcasting in the U.S.

HD Radio technology features include:

- Static-free, clear radio reception.
- FM Multicasting – the ability to broadcast multiple program streams over a single FM frequency.
- A variety of "data services," including text-based information – artist name, song title, etc. scrolled across your receiver display.
- Digital broadcasts in the same frequencies as analog broadcasts; listeners do not need to learn a new station number and today's stations remain at their current place on the dial.

HD Radio technology is developed and licensed by iBiquity Digital Corporation and supported by the leaders of the broadcasting, consumer electronics and automotive industries.

## Features

- High-fidelity FM (RBDS)/AM Digital Radio with HD Radio™ Technology.
- Furniture-grade, hand-lacquered surface.
- Wood based cabinet, stereo speakers and bass reflex sound system allows rich warm sound.
- Digital tuning control knob permits easy accurate tuning.
- Easy to see large, full-dot LCD display with backlight.
- High sensitive external FM/AM antenna.
- Full range 2.6 inch stereo speakers and cancel magnet system.
- Treble/bass tone control and surround sound functions.
- Alarm time setting (Radio, Buzzer or Line-In source).
- LINE IN jack for connecting other portable audio equipment.
- Headphone out (ø 3.5 mm stereo minijack).

## Precautions

- Play the unit on the power source specified in "Specifications".
- To disconnect the AC power cord (mains lead), pull it out by the plug, not the cord.
- The unit is not disconnected from the AC power source (mains) as long as it is connected to the wall outlet, even if the unit itself has been turned off.
- The nameplate indicating operating voltage, etc. is located on the bottom exterior.
- Since a strong magnet is used for the speaker, keep personal credit cards using magnetic coding or spring-wound watches away from the unit to prevent possible damage from the magnet.
- Do not leave the unit in a location near a heat source such as a radiator or airduct, or in a place subject to direct sunlight, excessive dust, mechanical vibration, or shock.
- Allow adequate air circulation to prevent internal heat build-up. Do not place the unit on a surface (a rug, a blanket, etc.) or near materials (a curtain) which might block the ventilation holes.
- Should any solid object or liquid fall into the unit, unplug the unit and have it checked by a qualified personnel before operating it any further.
- To clean the casing, use a soft cloth dampened with a mild detergent solution.
- Never touch the wire of the external FM antenna during a thunderstorm. Furthermore, immediately disconnect the AC power code from the radio.

If you have any questions or problems concerning your unit, please consult your nearest Sony dealer.

## Connecting the antenna

### To connect the AM loop antenna

The shape and the length of the antenna is designed to receive AM signals. Do not dismantle or roll up the antenna.

- 1 Remove only the loop part from the plastic stand.
- 2 Set up the AM loop antenna.

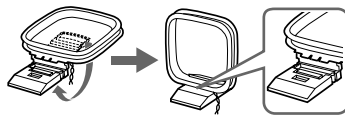

- 3 Connect the cords to the AM antenna terminals. Cord (A) or cord (B) can be connected to either terminal.

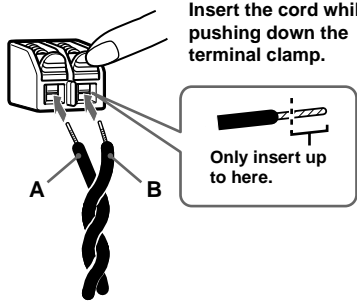

- 4 Make sure the AM loop antenna is connected firmly by pulling softly.

### Adjusting the AM loop antenna

Find a place and an orientation that provide good reception.

- Do not place the AM loop antenna near the unit or other AV equipment, as noise may result.
- If you use an external polarized AM antenna, be sure to connect the ground cord to the *A<sub>h</sub>* terminal. The supplied AM antenna cord has no polarity.

### Tip

Adjust the direction of the AM loop antenna for best AM broadcast sound.

### To connect the FM antenna

This unit comes supplied with an FM wire antenna and FM dipole antenna. Connect an antenna that provides good reception to the FM antenna terminal.

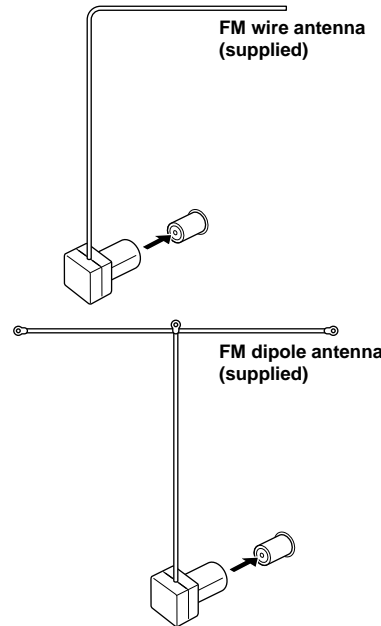

### Adjusting the FM wire antenna

Be sure to fully extend the FM wire antenna, and keep it as horizontal or vertical as possible.

### Adjusting the FM dipole antenna

Be sure to fully extend the FM dipole antenna. Attach the antenna in the shape of a T to a high position on a wall away from this unit.

### Tip

If you have poor FM reception, use a 75 Ω coaxial cable (not supplied) to connect the unit to an outdoor FM antenna as shown below.

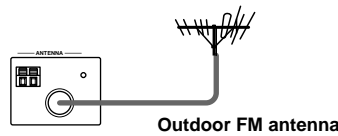

# IMPORTANT SAFEGUARDS

For your protection, please read these safety instructions completely before operating the appliance, and keep this manual for future reference. Carefully observe all warnings, precautions and instructions on the appliance and in the operating instructions, and adhere to them.

## INSTALLATION

### Water and Moisture

Do not use powerline operated appliances near water - for example, near a bathtub, washbowl, kitchen sink, or laundry tub, in a wet basement, or near a swimming pool, etc.

### Heat

Do not place the appliance near or over a radiator or heat register, or where it is exposed to direct sunlight.

### Ventilation

The slots and openings in the cabinet are provided for necessary ventilation. To ensure reliable operation of the appliance, and to protect it from overheating, these slots and openings must never be blocked or covered.

- Never cover the slots and openings with a cloth or other materials.
- Never block the slots and openings by placing the appliance on a bed, sofa, rug or other similar surface.
- Never place the appliance in a confined space, such as a bookcase, or built-in cabinet, unless proper ventilation is provided.

### Accessories

Do not place the appliance on an unstable cart, stand, tripod, bracket, or table. The appliance may fall, causing serious injury to a child or an adult, and serious damage to the appliance. Use only a cart, stand, tripod, bracket, or table recommended by Sony.

-An appliance and cart combination should be moved with care. Quick stops, excessive force, and uneven surfaces may cause the appliance and cart combination to overturn.

### Wall or Ceiling Mounting

If your appliance can be mounted to a wall or ceiling, mount it only as recommended by Sony.

## USE

### Power Source

This appliance should be operated only from the type of power source indicated on the marking label. If you are not sure of the type of electrical power supplied to your home, consult your dealer or local power company. For those appliances designed to operate from battery power, or other sources, refer to the operating instructions.

### Grounding or Polarization

This appliance is equipped with a polarized AC power cord plug (a plug having one blade wider than the other), or with a three-wire grounding type plug (a plug having a third pin for grounding). Follow the instructions below:

-**For the appliance with a polarized AC power cord plug:** This plug will fit into the power outlet only one way. This is a safety feature. If you are unable to insert the plug fully into the outlet, try reversing the plug. If the plug should still fail to fit, contact your electrician to have a suitable outlet installed. Do not defeat the safety purpose of the polarized plug by forcing it in.

-**For the appliance with a three-wire grounding type AC plug:** This plug will only fit into a grounding-type power outlet. This is a safety feature. If you are unable to insert the plug into the outlet, contact your electrician to have a suitable outlet installed. Do not defeat the safety purpose of the grounding plug.

### Overloading

Do not overload wall outlets, extension cords or convenience receptacles beyond their capacity, since this can result in fire or electric shock.

### When not in use

Unplug the power cord of the appliance from the outlet when left unused for a long period of time. To disconnect the cord, pull it out by grasping the plug. Never pull the plug out by the cord.

### Power-Cord Protection

Route the power cord so that it is not likely to be walked on or pinched by items placed upon or against them, paying particular attention to the plugs, receptacles, and the point where the cord exits from the appliance.

### Lightning

For added protection for this appliance during a lightning storm, or when it is left unattended and unused for long periods of time, unplug it from the wall outlet and disconnect the antenna or cable system. This will prevent damage to the appliance due to lightning and powerline surges.

### Object and Liquid Entry

Never push objects of any kind into the appliance through openings as they may touch dangerous voltage points or short out parts that could result in a fire or electric shock. Never spill liquid of any kind on the appliance.

### Cleaning

Unplug the appliance from the wall outlet before cleaning or polishing it. Do not use liquid cleaners or aerosol cleaners. Use a cloth lightly dampened with water for cleaning the exterior of the appliance. Clean the appliance only as recommended by Sony.

### Attachments

Do not use attachments not recommended by Sony, as they may cause hazards.

## ANTENNAS

### Outdoor Antenna Grounding

If an outdoor antenna or cable system is installed, follow the precautions below.

An outdoor antenna system should not be located in the vicinity of overhead power lines or other electric light or power circuits, or where it can come in contact with such power lines or circuits. WHEN INSTALLING AN OUTDOOR ANTENNA SYSTEM, EXTREME CARE SHOULD BE TAKEN TO KEEP FROM CONTACTING SUCH POWER LINES OR CIRCUITS AS CONTACT WITH THEM IS ALMOST INVARIABLY FATAL.

Be sure the antenna system is grounded so as to provide some protection against voltage surges and built-up static charges. Section 810 of the National Electrical Code provides information with respect to proper grounding of the mast and supporting structure, grounding of the lead-in wire to an antenna discharge unit, size of grounding conductors, location of antenna-discharge unit, connection to grounding electrodes, and requirements for the grounding electrode.

## Antenna Grounding According to the National Electrical Code

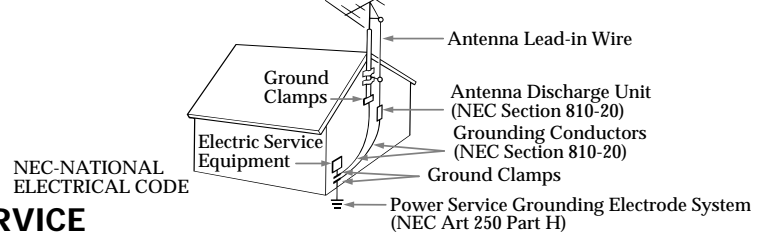

## SERVICE

### Damage Requiring Service

Unplug the appliance from the wall outlet and refer servicing to qualified service personnel under the following conditions:

- When the power cord or plug is damaged or frayed.
- If liquid has been spilled or objects have fallen into the appliance.
- If the appliance has been exposed to rain or water.
- The appliance does not appear to operate normally or exhibits a marked change in performance.
- This indicates a need for service.
- If the appliance does not operate normally when following the operating instructions, adjust only those controls that are specified in the operating instructions. Improper adjustment of other controls may result in damage and will often require extensive work by a qualified technician to restore the appliance to normal operation.
- If the appliance has been subject to excessive shock by being dropped, or the cabinet has been damaged.

### Servicing

Do not attempt to service the appliance yourself as opening or removing covers may expose you to dangerous voltage or other hazards. Refer all servicing to qualified service personnel.

### Replacement parts

When replacement parts are required, be sure the service technician has used replacement parts specified by Sony that have the same characteristics as the original parts. Unauthorized substitutions may result in fire, electric shock, or other hazards.

### Safety Check

Upon completion of any service or repairs to the appliance, ask the service technician to perform routine safety checks (as specified by Sony) to determine that the appliance is in safe operating condition.

SONY

Portable Audio

## LIMITED WARRANTY

(U.S. Only)

Sony Electronics Inc. ("Sony") warrants this product against defects in material or workmanship for the time periods and as set forth below. Pursuant to this Limited Warranty, Sony will, at its option, (i) repair the product using new or refurbished parts or (ii) replace the product with a new or refurbished product. For purposes of this Limited Warranty, "refurbished" means a product or part that has been returned to its original specifications. **In the event of a defect, these are your exclusive remedies.**

**Labor:** For a period of one (1) year from the original date of purchase of the product ("Labor Warranty"), Sony will, at its option, repair or replace with new or refurbished product, product determined to be defective. If Sony elects to replace the product after this Labor Warranty has expired but while the Parts Warranty below is still in effect, it will do so for the applicable labor charge.

**Parts:** For a period of one (1) year from the original date of purchase of product ("Parts Warranty"), Sony will supply new or refurbished replacement parts in exchange for parts determined to be defective.

This Limited Warranty covers only the hardware components packaged with the Product. It does not cover technical assistance for hardware or software usage and it does not cover any software products whether or not contained in the Product; any such software is provided "AS IS" unless expressly provided for in any enclosed software Limited Warranty. Please refer to the End User License Agreements included with the Product for your rights and obligations with respect to the software.

**Instructions:** To obtain warranty service, you must deliver the product, freight prepaid, in either its original packaging or packaging affording an equal degree of protection to the Sony authorized service facility specified. It is your responsibility to backup any data, software or other materials you may have stored or preserved on your unit. It is likely that such data, software, or other materials will be lost or reformatted during service and Sony will not be responsible for any such damage or loss. A dated purchase receipt is required. For specific instructions on how to obtain warranty service for your product,

Visit Sony's Web Site:  
[www.sony.com/service](http://www.sony.com/service)

Or call the Sony Customer Information Service Center  
1-800-222-SONY (7669)

For an accessory or part not available from your authorized dealer, call:

1-800-488-SONY (7669)

**Repair / Replacement Warranty:** This Limited Warranty shall apply to any repair, replacement part or replacement product for the remainder of the original Limited Warranty period or for ninety (90) days, whichever is longer. Any parts or product replaced under this Limited Warranty will become the property of Sony.

This Limited Warranty only covers product issues caused by defects in material or workmanship during ordinary consumer use; it does not cover product issues caused by any other reason, including but not limited to product issues due to commercial use, acts of God, misuse, limitations of technology, or modification of or to any part of the Sony product. This Limited Warranty does not cover Sony products sold AS IS or WITH ALL FAULTS or consumables (such as fuses or batteries). This Limited Warranty is invalid if the factory-applied serial number has been altered or removed from the product. This Limited Warranty is valid only in the United States.

**LIMITATION ON DAMAGES:** SONY SHALL NOT BE LIABLE FOR ANY INCIDENTAL OR CONSEQUENTIAL DAMAGES FOR BREACH OF ANY EXPRESS OR IMPLIED WARRANTY ON THIS PRODUCT.

**DURATION OF IMPLIED WARRANTIES:** EXCEPT TO THE EXTENT PROHIBITED BY APPLICABLE LAW, ANY IMPLIED WARRANTY OF MERCHANTABILITY OR FITNESS FOR A PARTICULAR PURPOSE ON THIS PRODUCT IS LIMITED IN DURATION TO THE DURATION OF THIS WARRANTY.

Some states do not allow the exclusion or limitation of incidental or consequential damages, or allow limitations on how long an implied warranty lasts, so the above limitations or exclusions may not apply to you. This Limited Warranty gives you specific legal rights and you may have other rights which vary from state to state.

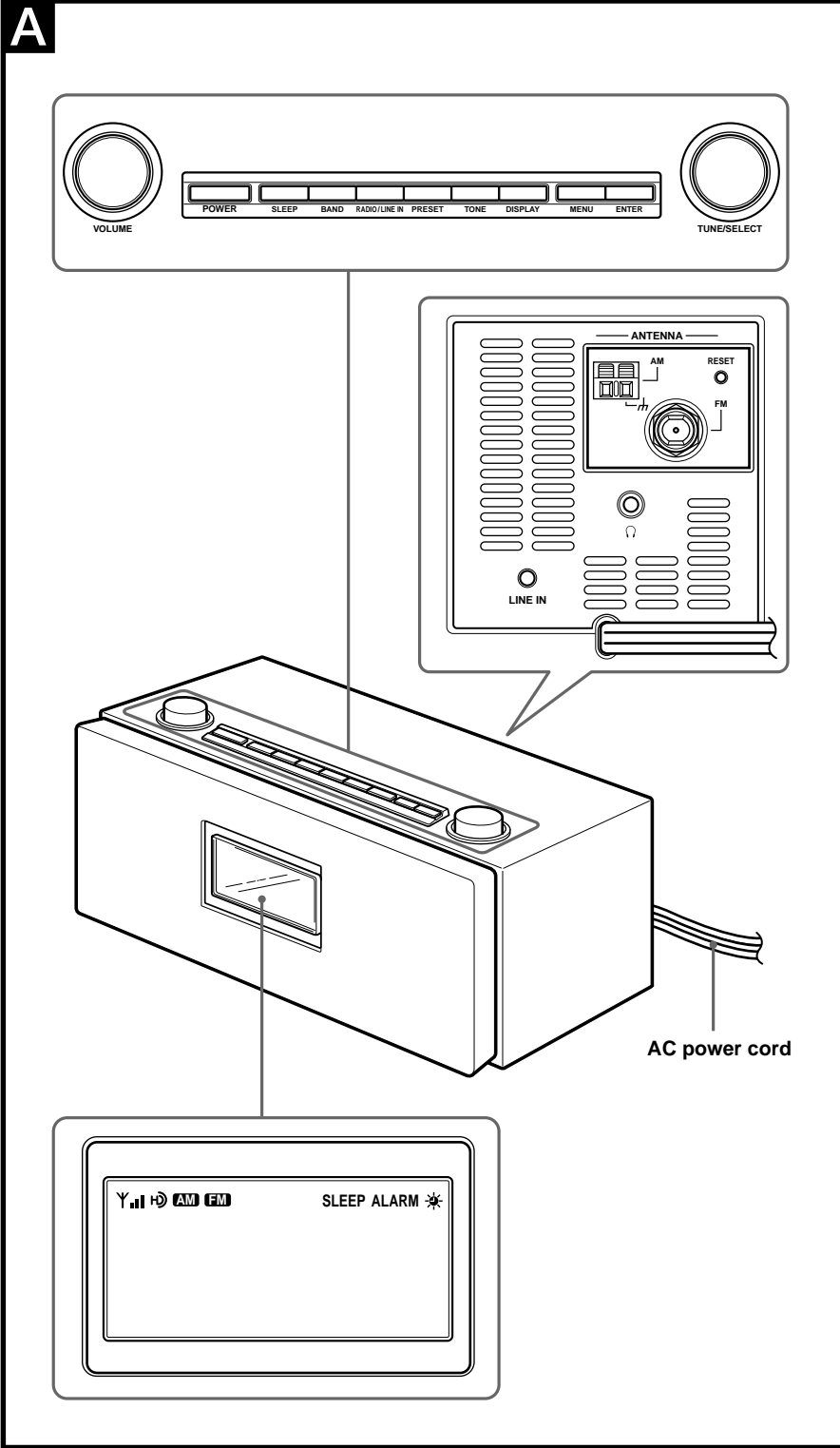

## Setting the clock

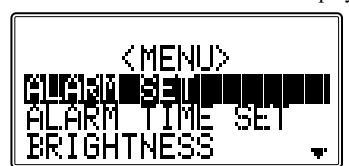
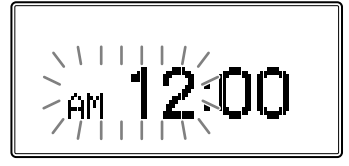
- 1 Plug in the unit.  
The display will flash "AM 12:00."
  - 2 Press MENU to show the menu display.
- 
- 3 Turn TUNE/SELECT clockwise to select "TIME SET," then press ENTER.  
The hour will start to flash in the display.
- 
- 4 Turn TUNE/SELECT clockwise or counterclockwise until current hour appears in the display, then press ENTER.  
The hour is set and the minutes start to flash.
  - 5 Repeat step 4 to set the minute.

**Note**  
If you do not set the menu within 65 seconds, the setting mode is canceled.

### To change the display to the daylight saving time (summer time) indication

- 1 Press MENU to show the menu display.
- 2 Turn TUNE/SELECT clockwise or counterclockwise to select "DST," then press ENTER.
- 3 Turn TUNE/SELECT counterclockwise to select "ON," then press ENTER.  
"\*" appears and the time indication changes to summer time.

To deactivate the DST function, select "OFF" in step 3.

## Playing the radio

### -Manual tuning

- 1 Press POWER to turn on the radio.  
If "LINE IN" is displayed, press RADIO/LINE IN so that the band (AM or FM) appears.
- 2 Press BAND to select the band AM or FM.
- 3 Turn TUNE/SELECT clockwise or counterclockwise to tune in to a desired frequency.  
A beep sounds when the minimum frequency of each band is received during tuning.
- 4 Adjust the volume using VOLUME.

**Tip**  
To attenuate the volume, turn VOLUME counterclockwise quickly.

**Note**  
The frequency cannot be input with the number buttons of the remote commander.

### -Preset tuning

- You can preset 20 stations each for AM and FM.
- Presetting a station**
- 1 Follow steps 1 to 3 in "Manual tuning" to tune the frequency you wish to preset.
  - 2 Press and hold PRESET for a few seconds.  
You will hear a beep.

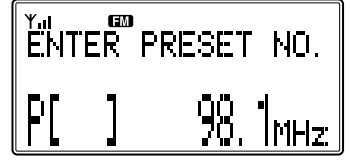

- 3 Turn TUNE/SELECT clockwise or counterclockwise to select the preset number, then press ENTER.  
The frequency is stored in the selected preset number and you will hear a beep.

To preset another station, repeat these steps.

**Note**  
If you try to store another station in the same preset number, the previously stored station will be replaced.

### Tuning in to a station

- 1 Press POWER to turn on the radio.
  - 2 Press BAND to select the band AM or FM.
  - 3 Press PRESET.
- The preset number appears in upper left in the display.
- 4 Turn TUNE/SELECT clockwise or counterclockwise to select the preset number.
  - 5 Adjust the volume using VOLUME.

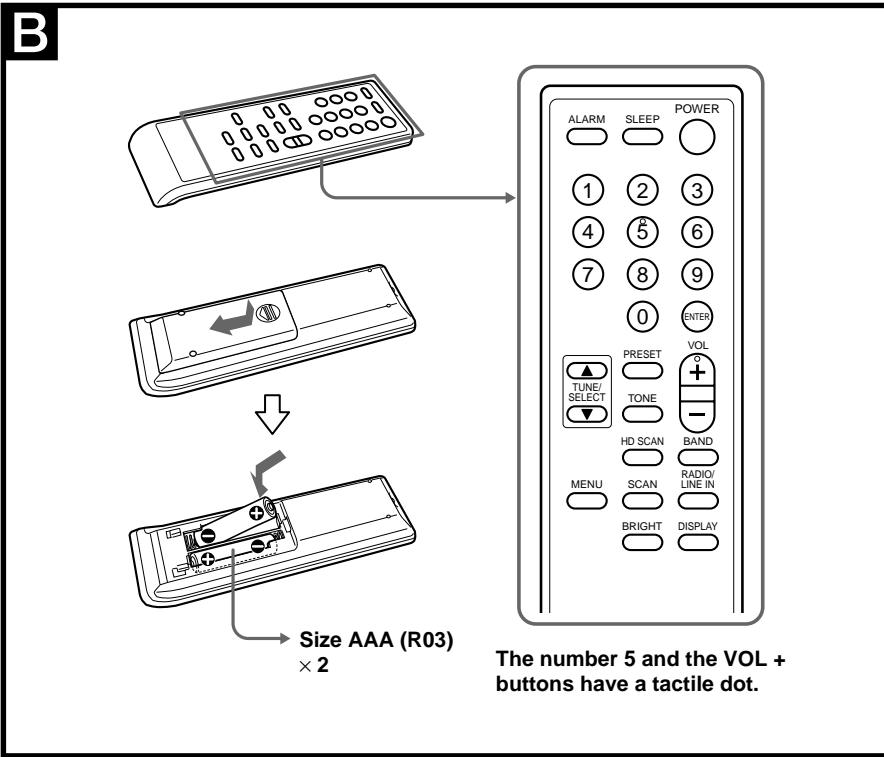

## Preparing the remote commander

### Installing the batteries into the remote commander (See Fig. B)

Insert two size AAA (R03) batteries (not supplied).

### When to replace the batteries

With normal use, the batteries should last for about six months. When the remote commander no longer operates the unit, replace all the batteries with new ones.

- Notes**
- Do not charge dry batteries.
  - When you are not going to use the remote commander for a long time, remove the batteries to avoid any damage caused by leakage and corrosion.

**Tip**  
The preset can be selected by pressing the number button of the remote commander. Press ENTER after the preset number is selected.

### -Scan tuning

- The unit will automatically scan the selected band. In HD scan, HD Radio stations are scanned.
- 1 Press POWER to turn on the radio.
  - 2 Press BAND to select the band AM or FM.
  - 3 Press MENU to show the menu display.
  - 4 Turn TUNE/SELECT clockwise or counterclockwise to select "SCAN" or "HD SCAN," then press ENTER.  
Scanning of the selected band starts.  
When a station is received, scanning pauses for 3 seconds and then continues.
  - 5 When the unit tunes in to the desired station, do any of the following operations to stop scanning.  
- Press ENTER on the unit or remote commander.  
- Press SCAN or HD SCAN on the remote commander.
  - 6 If necessary, turn TUNE/SELECT clockwise or counterclockwise to tune in to the station more precisely.
  - 7 Adjust the volume using VOLUME.

**Tip**  
You can scan a station directly by pressing SCAN or HD SCAN on the remote commander.

### To listen with the headphones

You can enjoy the radio and external equipment connected to the line in by the headphones (not supplied). Connect the headphones (not supplied) to the  $\phi$  (headphone) jack. The speaker is deactivated when the headphones are connected.

## Changing the display mode and settings

To change the display mode  
Press DISPLAY.  
The display changes as follows:

### When an analog radio station is received

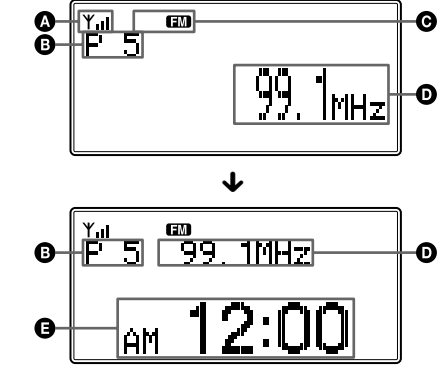

- A** Field strength level indicator
- B** Preset number\*
- C** Band
- D** Frequency
- E** Current time

\* When you tune in a station by selecting a preset number.

### When an analog FM broadcast that supports RBDS (Radio Broadcast Data System) is received

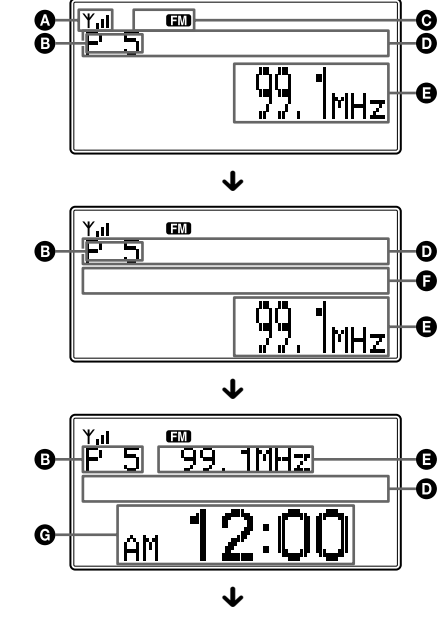

- A** Field strength level indicator
- B** Preset number\*
- C** Band
- D** Frequency
- E** Current time

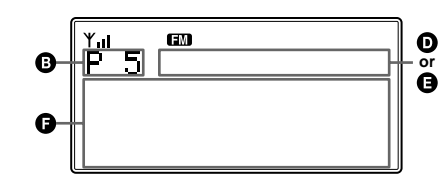

- A** Field strength level indicator
- B** Preset number\*
- C** Band
- D** Station name  
Name of station currently tuned in.
- E** Frequency
- F** Text information  
Text information transmitted from station.
- G** Current time

\* When you tune in a station by selecting a preset number.

**Note**  
The display item differs depending on the content of a broadcast or the station.

### When an HD Radio station is received

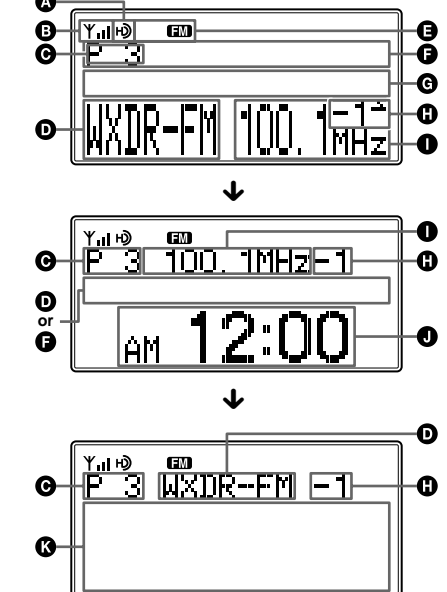

If you press DISPLAY for 2 seconds while the display above appears, the beep is heard and the scroll speed of the display item becomes slow.  
To return to normal scroll speed, press DISPLAY again for 2 seconds.

- A** HD indicator  
Lights: HD Radio reception level is sufficient (indicator flashes momentarily, and then stays lit).  
The sound changes from analog to digital.  
Flashes: HD Radio reception level is too low.  
The sound stays analog.  
If a HD Radio station signal is very weak, the indicator will not flash.
- B** Field strength level indicator
- C** Preset number\*
- D** Current station's call letters
- E** Band
- F** Station name and information
- G** Title/Artist name
- H** Sub channel (FM only)  
Appears when HD Radio broadcasts multiple program.  
Turn TUNE/SELECT clockwise or counterclockwise to select a sub channel.
- I** Frequency
- J** Current time
- K** Text information

\* When you tune in a station by selecting a preset number

**Note**  
The display item differs depending on the content of a broadcast or the station.

### To change the display settings (BRIGHTNESS/ CONTRAST)

- 1 Press MENU to show the menu display.
- 2 Turn TUNE/SELECT clockwise or counterclockwise to select "BRIGHTNESS" or "CONTRAST," then press ENTER.
- 3 Turn TUNE/SELECT clockwise or counterclockwise to select the setting or to adjust the level, then press ENTER.

**BRIGHTNESS:**  
The brightness of the display is selected from "HIGH," "MIDDLE" or "LOW."

**CONTRAST:**  
The contrast of the display can be adjusted by 11 levels.

**Note**  
If you do not set the menu within 10 seconds, the setting mode is canceled.

**Tip**  
You can adjust "BRIGHTNESS" directly by pressing BRIGHT on the remote commander.

## Adjusting the tone

- 1 Press POWER to turn on the radio.
- 2 Press TONE to show the tone setting display.



- 3 Turn TUNE/SELECT clockwise or counterclockwise to set "TREBLE," then press TONE.
- 4 Turn TUNE/SELECT clockwise or counterclockwise to set "BASS," then press TONE.
- 5 Turn TUNE/SELECT clockwise or counterclockwise to set "SURROUND," then press TONE.

**Tip**  
The adjustable range of "TREBLE" and "BASS" is from -6 to +6.  
"SURROUND" switches "ON" or "OFF."

## Setting the alarm

You can set the unit to turn on automatically at a preset time. The alarm can be set, even if the unit is off.  
To adjust the hour and minute, see "Setting the clock."

### To set the alarm time

- 1 Press MENU to show the menu display.
- 2 Turn TUNE/SELECT clockwise or counterclockwise to select "ALARM TIME SET," then press ENTER.  
The hour sign starts flashing.

#### Example of display when unit is off



- 3 Turn TUNE/SELECT clockwise or counterclockwise to set the hour, then press ENTER.  
The minute sign starts flashing.

- 4 Turn TUNE/SELECT clockwise or counterclockwise to set the minutes, then press ENTER.

- 5 Turn TUNE/SELECT clockwise or counterclockwise to select the source from "RADIO AM," "RADIO FM," "LINE IN" or "BUZZER," then press ENTER.  
If you select "RADIO AM," "RADIO FM" or "LINE IN" continue the following steps.
- 6 Turn TUNE/SELECT clockwise or counterclockwise to select the preset number, then press ENTER.  
If you selected "LINE IN" in step 5, this step is not necessary.
- 7 Turn TUNE/SELECT clockwise or counterclockwise to set the volume, then press ENTER.

### To set the alarm

- 1 Press MENU to show the menu display.
- 2 Turn TUNE/SELECT clockwise or counterclockwise to select "ALARM SET," then press ENTER.
- 3 Turn TUNE/SELECT counterclockwise to select "ON," then press ENTER.  
"ALARM" appears in the display.

#### Example of display when unit is off

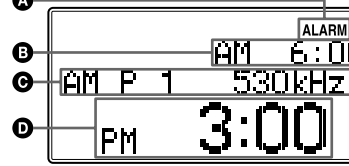

If you press DISPLAY while the display above appears, the display changes to the following.

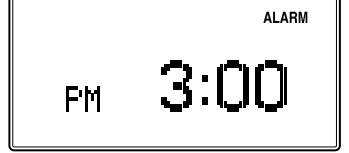

To return to the previous display, press DISPLAY again.

- A** ALARM indicator
- B** Alarm setting time
- C** Alarm setting (Source, Frequency, etc.)
- D** Current time

To deactivate the alarm function, turn TUNE/SELECT clockwise to select "OFF" in step 3.

### To stop the alarm

Press POWER on the unit or remote commander.

- Tips**
- To enter "ALARM TIME SET" mode directly, press and hold ALARM on the remote commander for 2 seconds.
  - You can activate or deactivate the alarm function directly by pressing ALARM on the remote commander.

- Notes**
- If you do not set the menu within 10 seconds, the setting mode is canceled.
  - If you do not operate the unit for 60 minutes after alarm sounds, the power is turned off.
  - If you select "LINE IN" source in "ALARM TIME SET," start playback on the external equipment. You cannot control the external equipment from this unit.

## Setting the sleep timer

You can enjoy falling asleep to the radio using the built-in sleep timer that turns off the radio automatically after a preset duration.

- 1 Press SLEEP.  
"SLEEP" and the digits for the sleep timer duration appear.

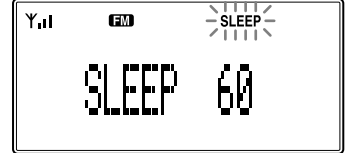

If you press SLEEP while the unit is turned off, the unit is turned on.

- 2 Press SLEEP repeatedly to select the desired sleep timer setting.  
Each press changes the setting time as follows:

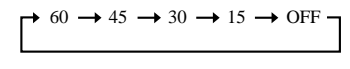

A beep sounds when the display returns to "SLEEP 60."  
After about 4 seconds, "SLEEP" lights in the display when the duration time is set.

The unit automatically turns off when the duration time is passed.

### To change the sleep timer setting

You can press SLEEP repeatedly to select the desired sleep timer setting even after the sleep timer has been activated.

### To deactivate the sleep timer

Press POWER to turn off the unit before the setting time has elapsed, or press SLEEP repeatedly to set the sleep timer to "SLEEP OFF" in step 2.

## Listening to the external equipment

- 1 Connect the LINE IN jack of the unit to the line out jack or headphone jack of the external equipment using the audio connecting cable (supplied).

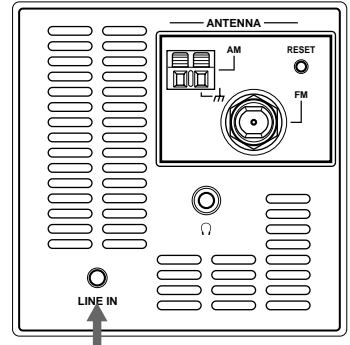

- 2 Press POWER to turn on the radio.
- 3 Press RADIO/LINE IN to select "LINE IN" in the display.

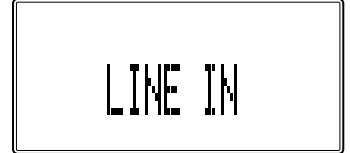

- 4 Play the equipment connected to the LINE IN jack.
- 5 Adjust the volume using VOLUME.

**Tip**  
To display the current time, press DISPLAY.

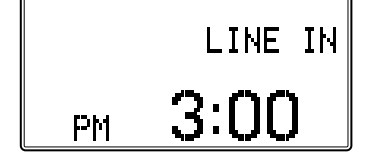

### To return to the radio

Press RADIO/LINE IN.  
The band (AM or FM) is shown in the display.

- Notes**
- Refer also to the connected equipment's manual.
  - The supplied audio connecting cable may not be used with some external equipment. In this case, use a cord suitable for the external equipment you are using.
  - When you listen to the radio with external equipment connected, turn off the connected equipment because noise may be caused. If noise continues, even when the equipment is turned off, disconnect and place the external equipment away from the unit.

## Resetting the unit

The RESET button is located on the rear of the unit. Press this button with a pointed object if the radio fails to function properly. The clock settings and stations you have preset, etc., will revert to the factory preset.

## Using the remote commander

Buttons shared on both the remote commander and the unit control the same functions.

**VOL +/- buttons**  
To adjust the volume.  
Press and hold the VOL - button for 2.5 seconds, the volume becomes minimized.

**ALARM button**  
Press to set the alarm to "ON" or "OFF."  
Press and hold for 2 seconds to enter "ALARM TIME SET."

**HD SCAN button**  
The selected band is scanned, and receivable HD Radio stations are received for 3 seconds in order of frequency.

**SCAN button**  
The selected band is scanned, and receivable radio stations are received for 3 seconds in order of frequency.

**BRIGHT button**  
To adjust the brightness of the display.

**Number buttons**  
To select a preset number (1 to 20).  
Press ENTER after the preset number is selected.  
If you input the number 0 or more than 21 and press ENTER, "ERROR" appears in the display.

## Specifications

- Time display**  
12-hour system
- Frequency range**  
FM : 87.5 - 108 MHz  
AM : 530 - 1,710 kHz
- Speaker**  
Approx. 6.6 cm (2 5/8 inches) dia. 4  $\Omega$
- Output**  
 $\phi$  (headphone) jack ( $\phi$  3.5 mm stereo minijack)
- Input**  
LINE IN jack ( $\phi$  3.5 mm stereo minijack)
- Antenna terminal**  
75  $\Omega$  antenna terminal for FM  
Antenna terminal for AM
- Power output**  
2.8 W + 2.8 W (at 10 % harmonic distortion)
- Power requirements**  
120 V AC, 60 Hz
- Dimensions**  
Approx. 300 x 120 x 169 mm (w/h/d)  
(11 7/8 x 4 3/4 x 6 3/4 inches) not incl. projecting parts and controls
- Mass**  
Approx. 3.6 kg (7 lb 15.8 oz) incl. power supply unit
- Supplied accessories**  
Remote commander (1)  
FM wire antenna (1)  
FM dipole antenna (1)  
AM loop antenna (1)  
Audio connecting cable (1)

Design and specifications are subject to change without notice.